



Price

£1,300 PCM

Fees Apply



Available 17/01/26

**Stuart Road Gravesend
DA11**

Wards
Helping you move forwards



Main Features

- First floor flat
- Ensuite to main bedroom
- Open plan kitchen/lounge
- Close to Gravesend town centre
- Close to amenities
- Deposit alternative considered



Deposit required is £1,500.00
Gravesham District - Council Tax Band Tax Band C

Renting a property is a big commitment and we recommend that you visit the local authority website and these websites which offer helpful information and advice about letting

www.gov.uk/government/publications/how-to-rent

www.gov.uk/private-renting

www.wardsofkent.co.uk/renting/tenancy-fees-individuals/

www.gov.uk/green-deal-energy-saving-measures

Call Dartford 01322 311291 ■ wardsofkent.co.uk

IMPORTANT INFORMATION: Please contact our Lettings Team who will confirm the total costs involved in renting this property. For clarification, we wish to inform the prospective tenant that we have prepared these details as a general guide. The agent has not carried out a detailed survey nor tested the services, appliances, or specific fittings (unless otherwise stated), and no warranty can be given as to their condition. All room measurements are taken at floor level. We strongly recommend that all the information which we provide about the property is verified by yourself and your advisers. The contents of this publication are © Wards, 2015. Wards is a trading name of Arun Estates Limited Registered in England No. 2597969

Accommodation

Entrance Hall

Kitchen/Lounge 3.84m x 7.26m

Bedroom 1 3.10m x 2.97m

En- suite Shower Room 1.44m x 1.33m

Bathroom 1.55m x 2.29m

Bedroom 2 4.26m x 2.59m

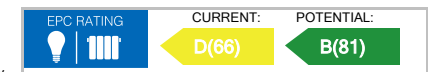

Ground Floor

Approx. 62.3 sq. metres (670.1 sq. feet)

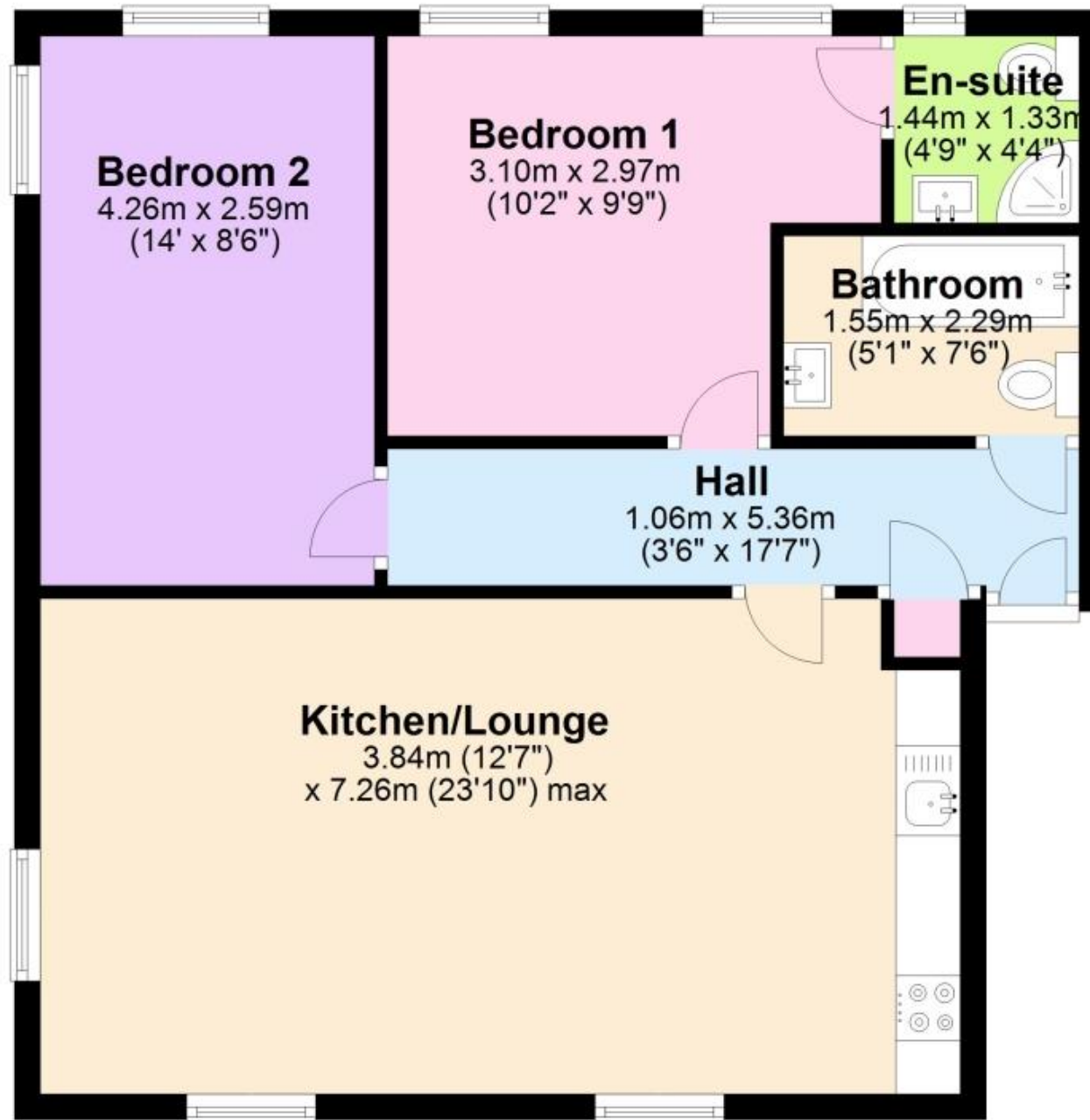

Total area: approx. 62.3 sq. metres (670.1 sq. feet)