



**Price**

**£1,100 PCM**

Fees Apply



Available 12/12/25

**Queen Street Arundel  
BN18**

**cubitt & west**  
Helping you move forwards



## Main Features

Sunny apartment  
Over 60's  
Central Arundel  
Lift  
Communal lounge  
Laundry Room



**Deposit required is £1,269.23**  
**Arun District - Council Tax Band Tax Band B**

Renting a property is a big commitment and we recommend that you visit the local authority website and these websites which offer helpful information and advice about letting

[www.gov.uk/government/publications/how-to-rent](http://www.gov.uk/government/publications/how-to-rent)

[www.gov.uk/private-renting](http://www.gov.uk/private-renting)

[www.cubittandwest.co.uk/renting/tenancy-fees-individuals/](http://www.cubittandwest.co.uk/renting/tenancy-fees-individuals/)

[www.gov.uk/green-deal-energy-saving-measures](http://www.gov.uk/green-deal-energy-saving-measures)

**Call Chichester 01243 774772 ■ [cubittandwest.co.uk](http://cubittandwest.co.uk)**

IMPORTANT INFORMATION: Please contact our Lettings Team who will confirm the total costs involved in renting this property. For clarification, we wish to inform the prospective tenant that we have prepared these details as a general guide. The agent has not carried out a detailed survey nor tested the services, appliances, or specific fittings (unless otherwise stated), and no warranty can be given as to their condition. All room measurements are taken at floor level. We strongly recommend that all the information which we provide about the property is verified by yourself and your advisers. The contents of this publication are © Cubitt & West, 2015. Cubitt & West is a trading name of Arun Estates Limited Registered in England No. 2597969

## Accommodation

**Living Room / Diner** 17'4 x 10'9

**Kitchen** 8'3 x 7'5

**Bedroom Inc. Storage** 16'3 x 9'0

**Shower Room** 7'1 x 5'5

**Lift Access**

**Communal Lounge**





## Second Floor

Approx. 45.7 sq. metres (492.0 sq. feet)

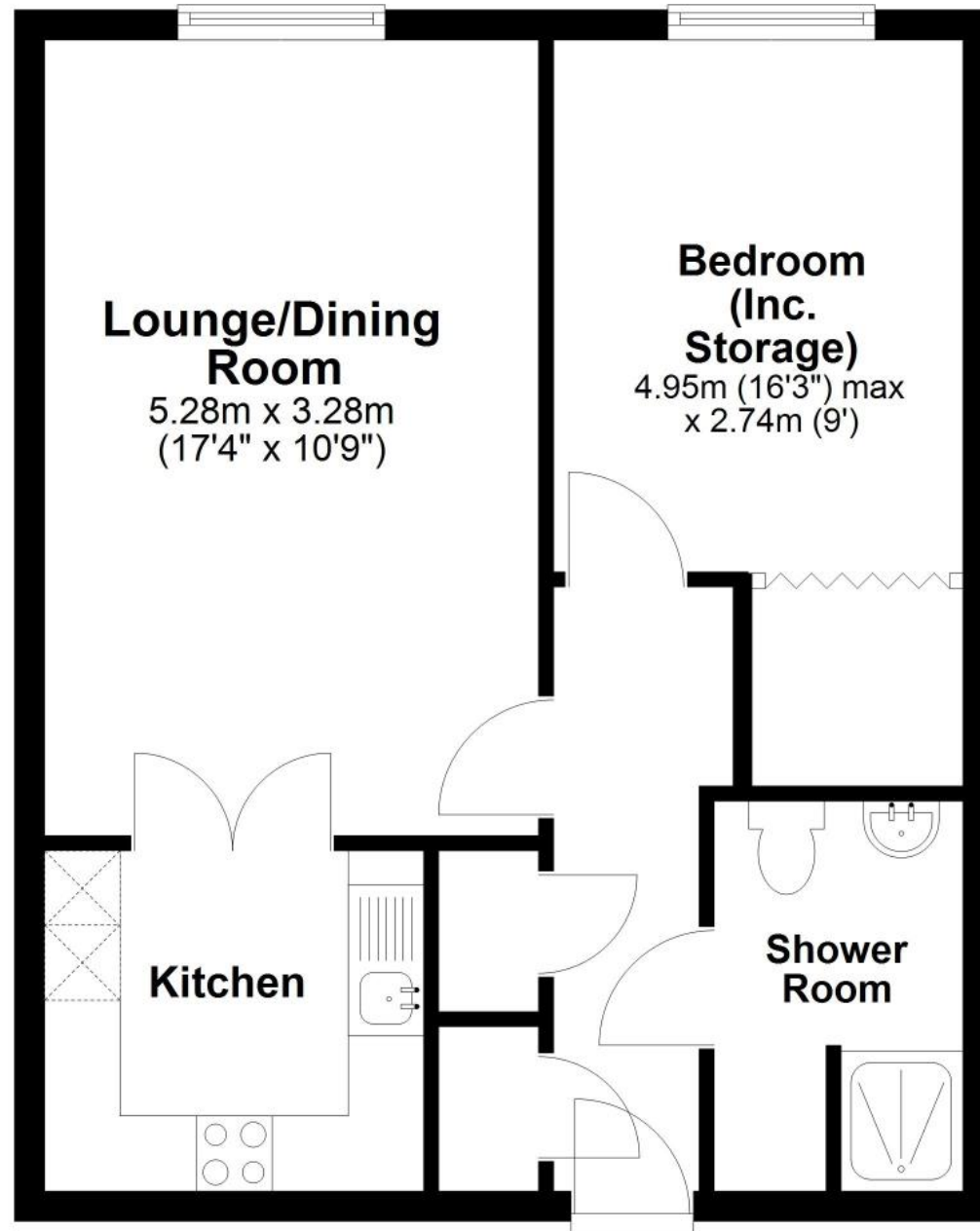

Total area: approx. 45.7 sq. metres (492.0 sq. feet)