



## Price

£1,750 PCM

Fees Apply



Available 26/10/24

Meadow Way Dartford  
DA2

*Wards*

Helping you move forwards



## Main Features

Semi-detached family home

Driveway

Garage

Two reception rooms

Ideally located for reputable schools

Front & rear gardens



Deposit required is £2,019.23  
Dartford District - Council Tax Band Tax Band D

Renting a property is a big commitment and we recommend that you visit the local authority website and these websites which offer helpful information and advice about letting

[www.gov.uk/government/publications/how-to-rent](http://www.gov.uk/government/publications/how-to-rent)

[www.gov.uk/private-renting](http://www.gov.uk/private-renting)

[www.wardsofkent.co.uk/renting/tenancy-fees-individuals/](http://www.wardsofkent.co.uk/renting/tenancy-fees-individuals/)

[www.gov.uk/green-deal-energy-saving-measures](http://www.gov.uk/green-deal-energy-saving-measures)

Call Dartford 01322 311291 ■ [wardsofkent.co.uk](http://wardsofkent.co.uk)

IMPORTANT INFORMATION: Please contact our Lettings Team who will confirm the total costs involved in renting this property. For clarification, we wish to inform the prospective tenant that we have prepared these details as a general guide. The agent has not carried out a detailed survey nor tested the services, appliances, or specific fittings (unless otherwise stated), and no warranty can be given as to their condition. All room measurements are taken at floor level. We strongly recommend that all the information which we provide about the property is verified by yourself and your advisers. The contents of this publication are © Wards, 2015. Wards is a trading name of Arun Estates Limited Registered in England No. 2597969

## Accommodation

Porch

Lounge 4.90m x 3.79m

Kitchen 2.99m x 2.70m

Dining Room 3.01m x 2.87m

Bathroom 1.83m x 1.50m

Separate Toilet 1.85m x 0.77m

Bedroom 1 3.92m x 3.24m

Bedroom 2 2.73m x 3.39m

Bedroom 3 2.80m x 2.40m

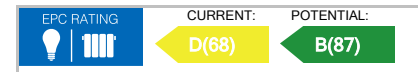

## Ground Floor

Approx. 48.4 sq. metres (520.9 sq. feet)

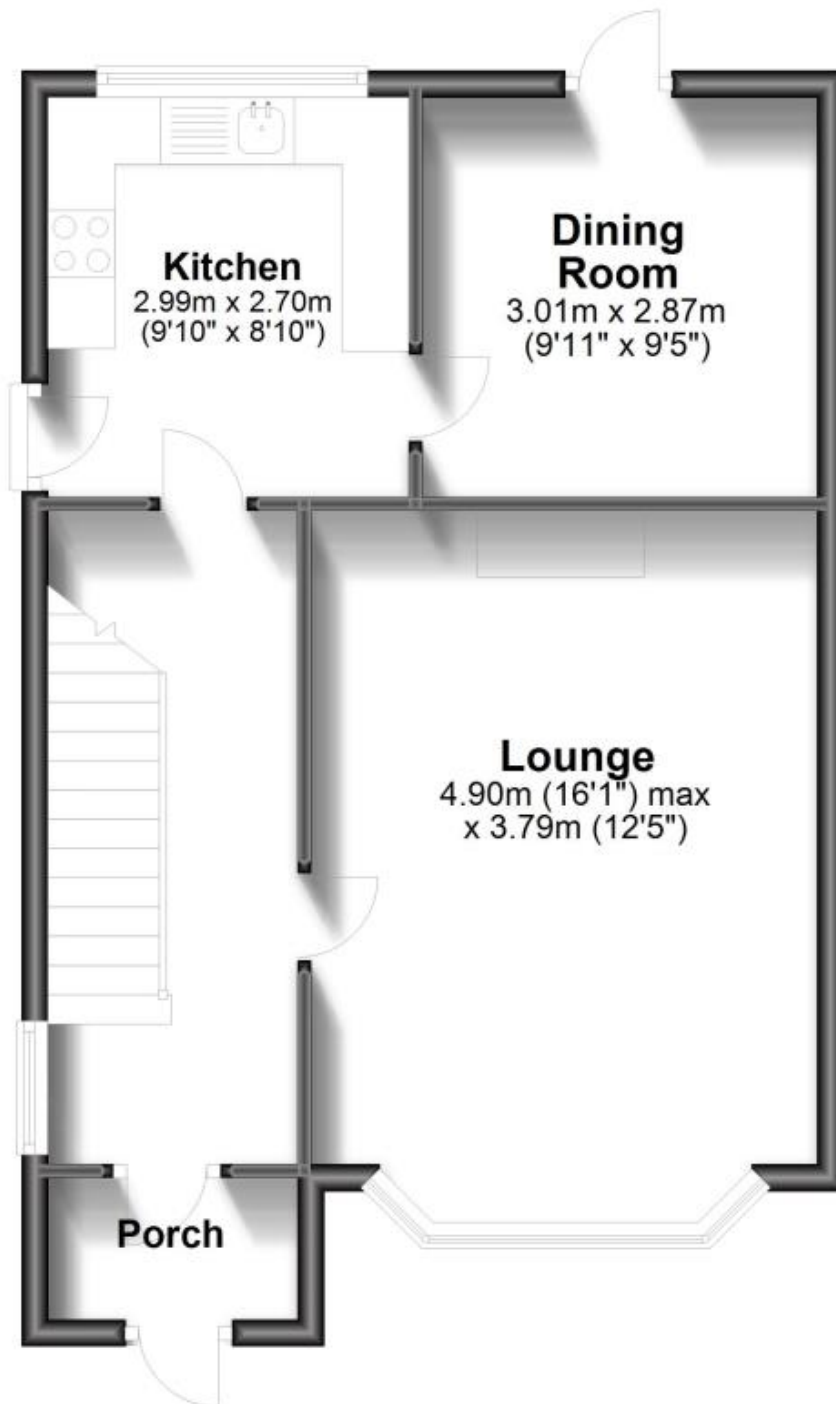

## First Floor

Approx. 41.1 sq. metres (442.0 sq. feet)

