



Price

£2,000 PCM

Fees Apply



Available 31/08/24

Meadow Way Dartford
DA2

Wards

Helping you move forwards



Main Features

- Semi-detached family home
- Driveway
- Garage
- Two reception rooms
- Ideally located for reputable schools
- Front & rear gardens



Deposit required is £2,307.69
Dartford District - Council Tax Band Tax Band D

Renting a property is a big commitment and we recommend that you visit the local authority website and these websites which offer helpful information and advice about letting

www.gov.uk/government/publications/how-to-rent

www.gov.uk/private-renting

www.wardsofkent.co.uk/renting/tenancy-fees-individuals/

www.gov.uk/green-deal-energy-saving-measures

Call Dartford 01322 311291 ■ wardsofkent.co.uk

IMPORTANT INFORMATION: Please contact our Lettings Team who will confirm the total costs involved in renting this property. For clarification, we wish to inform the prospective tenant that we have prepared these details as a general guide. The agent has not carried out a detailed survey nor tested the services, appliances, or specific fittings (unless otherwise stated), and no warranty can be given as to their condition. All room measurements are taken at floor level. We strongly recommend that all the information which we provide about the property is verified by yourself and your advisers. The contents of this publication are © Wards, 2015. Wards is a trading name of Arun Estates Limited Registered in England No. 2597969

Accommodation

Porch

Lounge 4.90m x 3.79m

Kitchen 2.99m x 2.70m

Dining Room 3.01m x 2.87m

Bathroom 1.83m x 1.50m

Separate Toilet 1.85m x 0.77m

Bedroom 1 3.92m x 3.24m

Bedroom 2 2.73m x 3.39m

Bedroom 3 2.80m x 2.40m

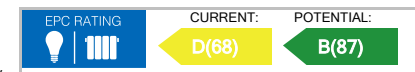

Ground Floor

Approx. 48.4 sq. metres (520.9 sq. feet)

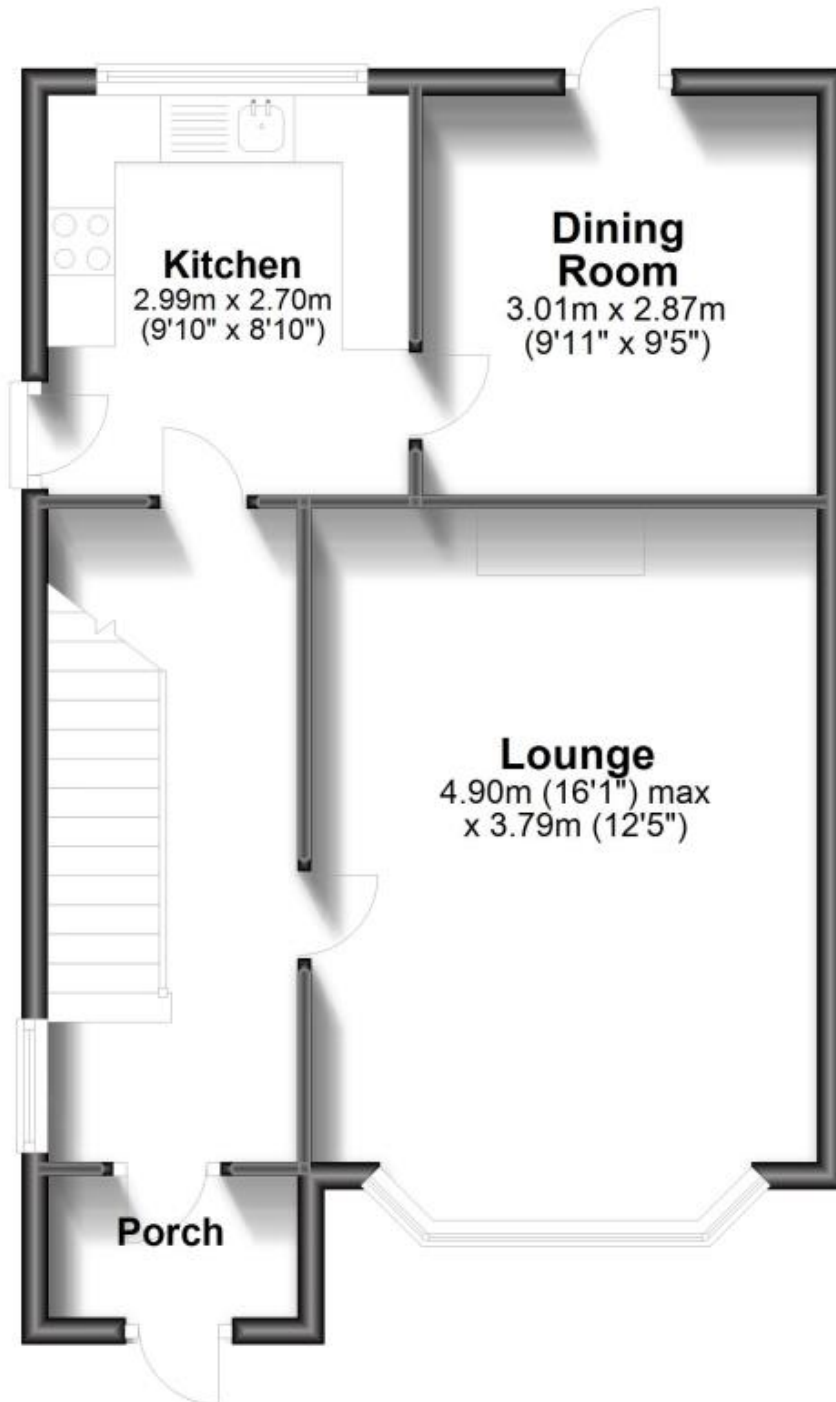

First Floor

Approx. 41.1 sq. metres (442.0 sq. feet)

