



## Price

£1,500 PCM

Fees Apply



Available 04/03/24

Springfield Avenue  
Telscombe Cliffs BN10

**cubitt & west**  
Helping you move forwards

## Main Features

- Six month let
- Three bedrooms
- Two bathrooms
- Garden
- Driveway
- Furnished



Deposit required is £1,730.77  
Lewes District - Council Tax Band Tax Band E

## Accommodation

Lounge/Dining Room  
Open Plan Kitchen  
Family Room  
Shower Room  
Master Bedroom  
Second Bedroom  
Third Bedroom  
Family Bathroom  
Driveway  
Garden

Garage

Renting a property is a big commitment and we recommend that you visit the local authority website and these websites which offer helpful information and advice about letting

[www.gov.uk/government/publications/how-to-rent](http://www.gov.uk/government/publications/how-to-rent)

[www.gov.uk/private-renting](http://www.gov.uk/private-renting)

[www.cubittandwest.co.uk/renting/tenancy-fees-individuals/](http://www.cubittandwest.co.uk/renting/tenancy-fees-individuals/)

[www.gov.uk/green-deal-energy-saving-measures](http://www.gov.uk/green-deal-energy-saving-measures)

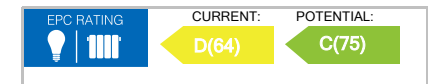

Call Brighton 01273 747525 ■ [cubittandwest.co.uk](http://cubittandwest.co.uk)

IMPORTANT INFORMATION: Please contact our Lettings Team who will confirm the total costs involved in renting this property. For clarification, we wish to inform the prospective tenant that we have prepared these details as a general guide. The agent has not carried out a detailed survey nor tested the services, appliances, or specific fittings (unless otherwise stated), and no warranty can be given as to their condition. All room measurements are taken at floor level. We strongly recommend that all the information which we provide about the property is verified by yourself and your advisers. The contents of this publication are © Cubitt & West, 2015. Cubitt & West is a trading name of Arun Estates Limited Registered in England No. 2597969



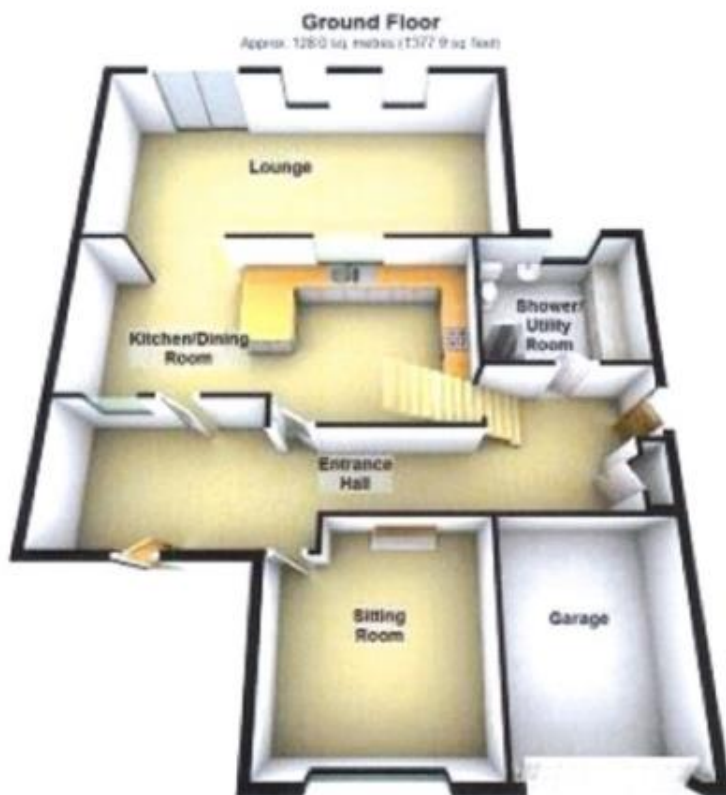

Total area: approx. 208.6 sq. metres (2245.8 sq. feet)  
Please note that this Floor Plan is for identification purposes and the measurements should not be relied upon.  
Plan produced using The Mobile Agent.