



## Price

£1,500 PCM

Fees Apply



Available 01/10/23

Tilbury Road Rainham  
ME8

*Wards*

Helping you move forwards





## Main Features

- Walking Distance Of Station
- Modern Fitted Kitchen
- Available Now
- Low Maintenance Garden
- Energy Rating C
- Ideal Family Home



Deposit required is £1,730.77  
Medway - Council Tax Band Tax Band C

Renting a property is a big commitment and we recommend that you visit the local authority website and these websites which offer helpful information and advice about letting

[www.gov.uk/government/publications/how-to-rent](http://www.gov.uk/government/publications/how-to-rent)

[www.gov.uk/private-renting](http://www.gov.uk/private-renting)

[www.wardsofkent.co.uk/renting/tenancy-fees-individuals/](http://www.wardsofkent.co.uk/renting/tenancy-fees-individuals/)

[www.gov.uk/green-deal-energy-saving-measures](http://www.gov.uk/green-deal-energy-saving-measures)

Call Medway 01634 714848 ■ [wardsofkent.co.uk](http://wardsofkent.co.uk)

IMPORTANT INFORMATION: Please contact our Lettings Team who will confirm the total costs involved in renting this property. For clarification, we wish to inform the prospective tenant that we have prepared these details as a general guide. The agent has not carried out a detailed survey nor tested the services, appliances, or specific fittings (unless otherwise stated), and no warranty can be given as to their condition. All room measurements are taken at floor level. We strongly recommend that all the information which we provide about the property is verified by yourself and your advisers. The contents of this publication are © Wards, 2015. Wards is a trading name of Arun Estates Limited Registered in England No. 2597969

## Accommodation

Covered Entrance  
Dining Room 3.38 x 2.28  
Fitted Kitchen 3.38 x 2.76  
First Floor Landing  
Lounge 3.49 x 3.4  
Bedroom 2 2.81 x 2.3  
WC  
Second Floor Landing  
Bedroom 1 3.5 x 3.4  
Bedroom 3 2.8 x 1.8

Bathroom  
Rear Garden  
Driveway  
Store Room

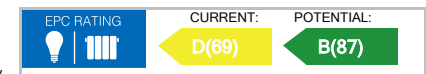

## Ground Floor

Approx. 30.6 sq. metres (329.2 sq. feet)

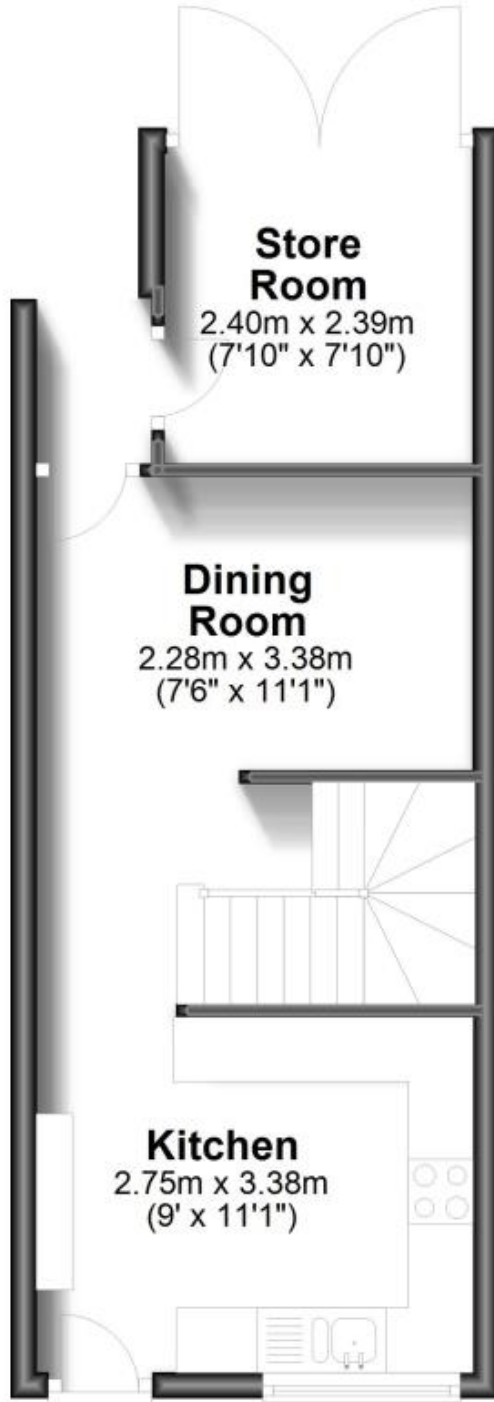

## First Floor

Approx. 27.8 sq. metres (299.6 sq. feet)

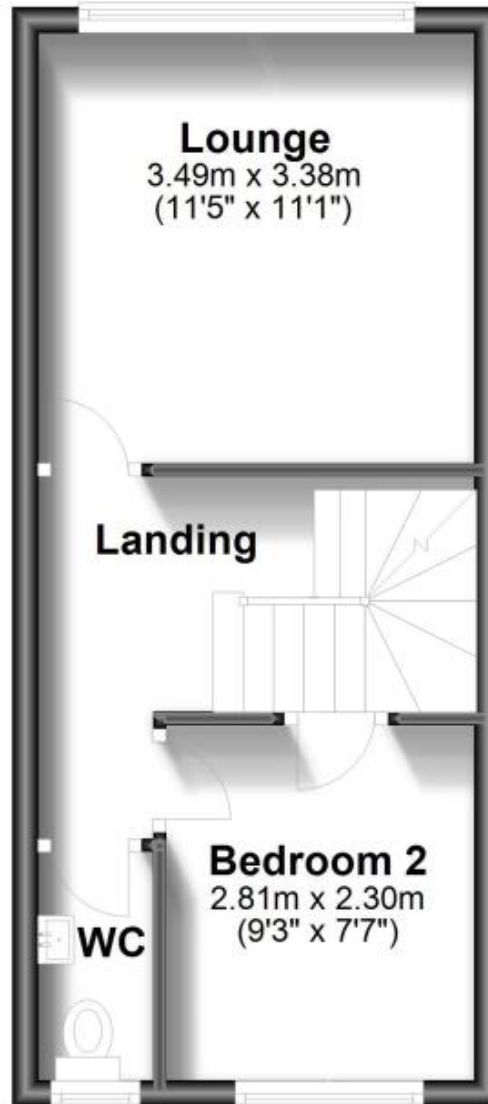

## Second Floor

Approx. 27.8 sq. metres (299.3 sq. feet)

