



## Price

£1,900 PCM

Fees Apply



Available 15/05/23

Finchale Road London  
SE2

*Wards*

Helping you move forwards



## Main Features

- Mid-terrace family home
- Excellent storage space throughout
- Driveway
- Kitchen/Diner
- Generous garden area
- Ideally located for reputable schools



Deposit required is £2,192.31  
Greenwich London - Council Tax Band Tax Band C

Renting a property is a big commitment and we recommend that you visit the local authority website and these websites which offer helpful information and advice about letting

[www.gov.uk/government/publications/how-to-rent](http://www.gov.uk/government/publications/how-to-rent)

[www.gov.uk/private-renting](http://www.gov.uk/private-renting)

[www.wardsofkent.co.uk/renting/tenancy-fees-individuals/](http://www.wardsofkent.co.uk/renting/tenancy-fees-individuals/)

[www.gov.uk/green-deal-energy-saving-measures](http://www.gov.uk/green-deal-energy-saving-measures)

Call Dartford 01322 311291 ■ [wardsofkent.co.uk](http://wardsofkent.co.uk)

IMPORTANT INFORMATION: Please contact our Lettings Team who will confirm the total costs involved in renting this property. For clarification, we wish to inform the prospective tenant that we have prepared these details as a general guide. The agent has not carried out a detailed survey nor tested the services, appliances, or specific fittings (unless otherwise stated), and no warranty can be given as to their condition. All room measurements are taken at floor level. We strongly recommend that all the information which we provide about the property is verified by yourself and your advisers. The contents of this publication are © Wards, 2015. Wards is a trading name of Arun Estates Limited Registered in England No. 2597969

## Accommodation

Porch

Entrance Hall

Lounge 4.84m x 3.20m

Kitchen/Diner 5.43m x 2.19m

Landing

Bedroom 1 3.90m x 2.91m

Bedroom 2 3.10m x 2.20m

Bedroom 3 2.68m x 2.51m

Bathroom 2.16m x 2.25m



## Ground Floor

Approx. 42.0 sq. metres (452.0 sq. feet)

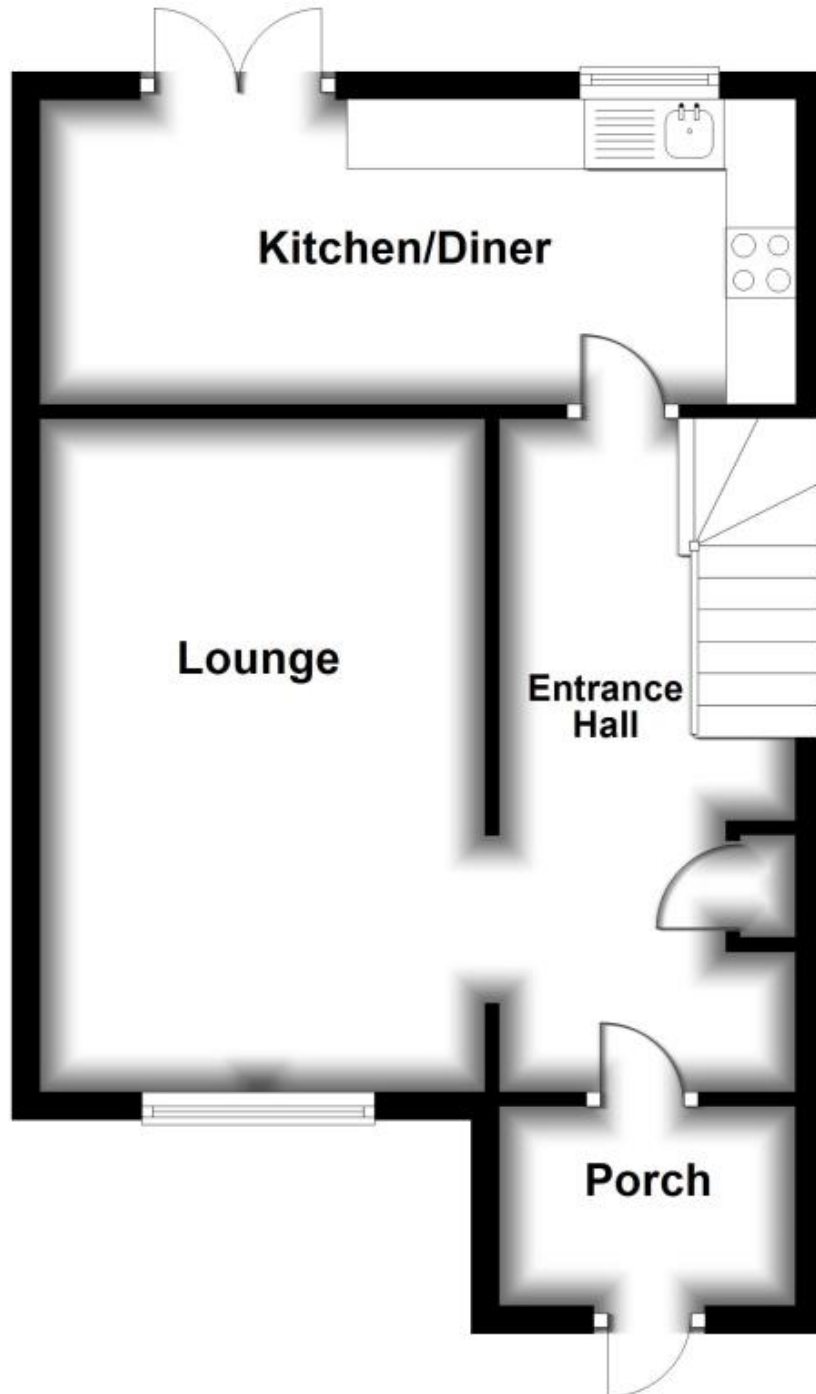

## First Floor

Approx. 40.9 sq. metres (440.8 sq. feet)

