



Price

£950 PCM

Fees Apply



Available 24/04/21

St. Georges Court
Longmere Road RH10

cubitt&west
Helping you move forwards



Main Features

- Close to town centre
- White goods included
- Storage throughout
- Parking
- Communal secure entry
- Available now



Deposit required is £1,096.15
Crawley District - Council Tax Band Tax Band B

Renting a property is a big commitment and we recommend that you visit the local authority website and these websites which offer helpful information and advice about letting

www.gov.uk/government/publications/how-to-rent

www.gov.uk/private-renting

www.cubittandwest.co.uk/renting/tenancy-fees-individuals/

www.gov.uk/green-deal-energy-saving-measures

Call Crawley 01293 544100 ■ cubittandwest.co.uk

IMPORTANT INFORMATION: Please contact our Lettings Team who will confirm the total costs involved in renting this property. For clarification, we wish to inform the prospective tenant that we have prepared these details as a general guide. The agent has not carried out a detailed survey nor tested the services, appliances, or specific fittings (unless otherwise stated), and no warranty can be given as to their condition. All room measurements are taken at floor level. We strongly recommend that all the information which we provide about the property is verified by yourself and your advisers. The contents of this publication are © Cubitt & West, 2015. Cubitt & West is a trading name of Arun Estates Limited Registered in England No. 2597969

Accommodation

- Lounge 5.01m x 2.58m
- Kitchen 3.41m x 2.21m
- Bedroom 1 3.39m x 2.95m
- Bedroom 2 2.95m x 2.03m
- Bathroom 1.97m x 1.96m

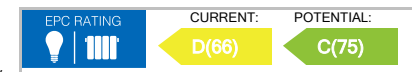

Ground Floor

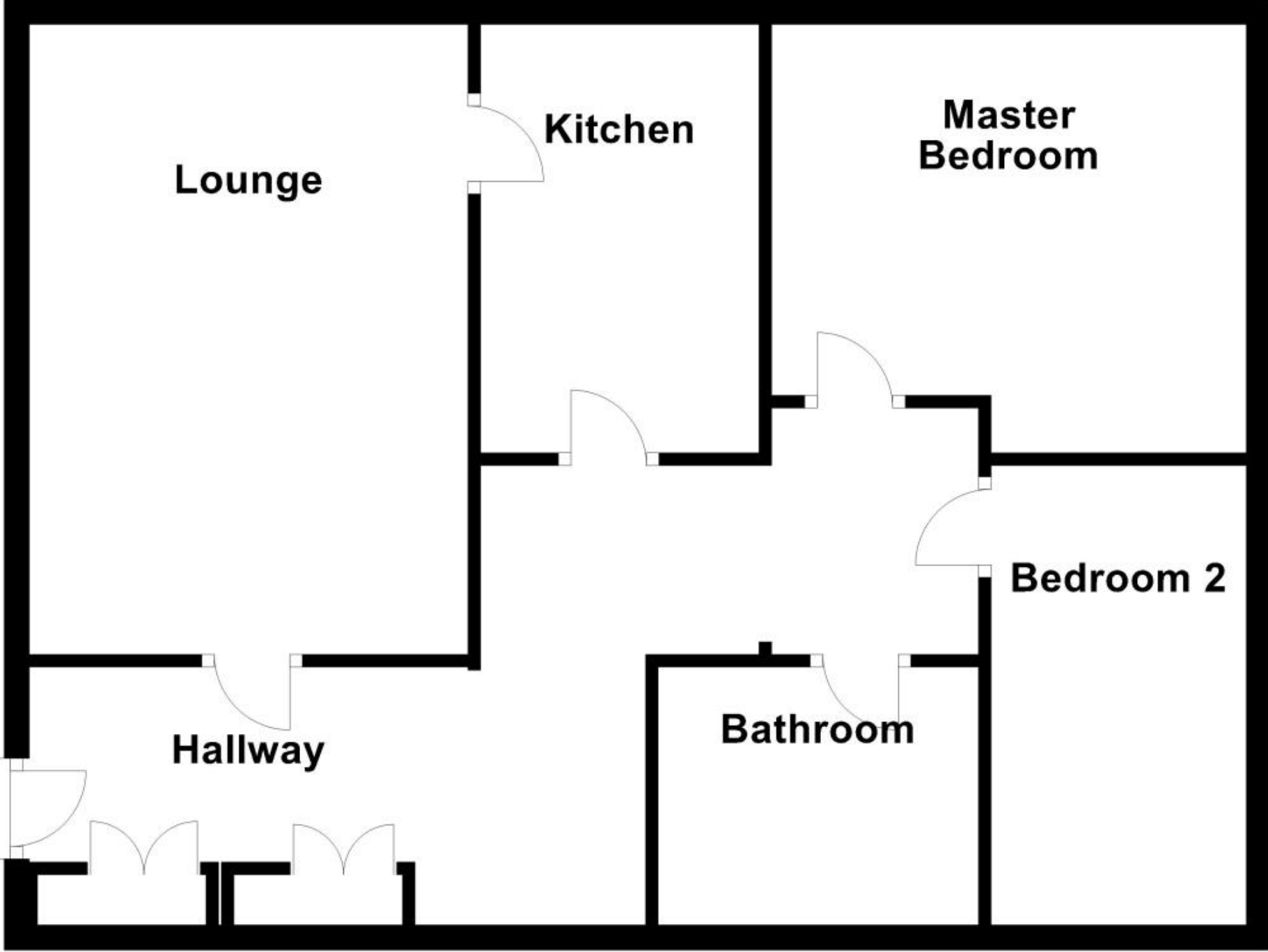

Lounge

Kitchen

Master
Bedroom

Bedroom 2

Bathroom

Hallway