



## Price

£1,650 PCM

Fees Apply



Available 26/10/20

The Green Bearsted  
ME14

*Wards*

Helping you move forwards



## Main Features

- Video Walk About Available
- End Of Terrace Cottage
- Four Good Size Bedrooms
- En Suite & Family Bathroom
- Garage & Parking
- Stylish Accommodation Set Over 3 Floors



Deposit required is £1,903.85  
Maidstone District - Council Tax Band Tax Band E

Renting a property is a big commitment and we recommend that you visit the local authority website and these websites which offer helpful information and advice about letting

[www.gov.uk/government/publications/how-to-rent](http://www.gov.uk/government/publications/how-to-rent)

[www.gov.uk/private-renting](http://www.gov.uk/private-renting)

[www.wardsofkent.co.uk/renting/tenancy-fees-individuals/](http://www.wardsofkent.co.uk/renting/tenancy-fees-individuals/)

[www.gov.uk/green-deal-energy-saving-measures](http://www.gov.uk/green-deal-energy-saving-measures)

Call Maidstone 01622 675064 ■ [wardsofkent.co.uk](http://wardsofkent.co.uk)

IMPORTANT INFORMATION: Please contact our Lettings Team who will confirm the total costs involved in renting this property. For clarification, we wish to inform the prospective tenant that we have prepared these details as a general guide. The agent has not carried out a detailed survey nor tested the services, appliances, or specific fittings (unless otherwise stated), and no warranty can be given as to their condition. All room measurements are taken at floor level. We strongly recommend that all the information which we provide about the property is verified by yourself and your advisers. The contents of this publication are © Wards, 2015. Wards is a trading name of Arun Estates Limited Registered in England No. 2597969

## Accommodation

Living Area 5.15x3.46

Dining Area 5.15x3.48

Kitchen Area 3.25x3.08

Stairs To 1st Floor

Master Bedroom 3.92x3.73

En Suite & Walk In Wrdrobe 3.92x1.47

Bedroom 2 3.73x3.62

Bathroom 2.12x1.80

Stairs To 2nd Floor

Bedroom 3 4.11x3.97

Bedroom 4 3.23x3.22

Garage & Driveway

Garden

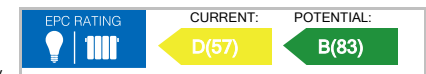

**Ground Floor**

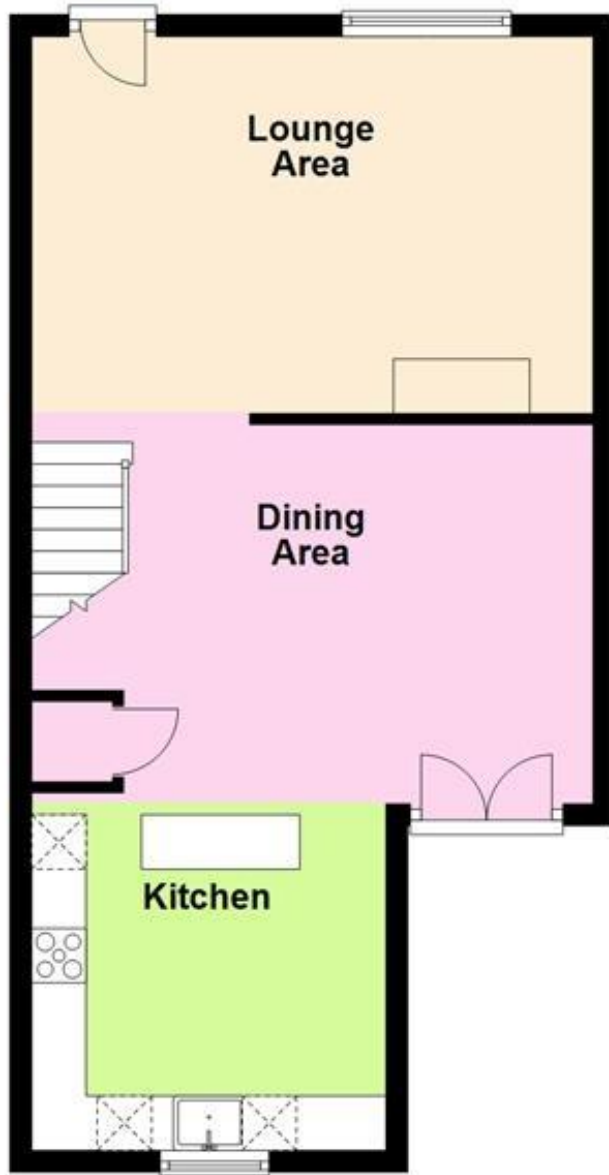

**First Floor**

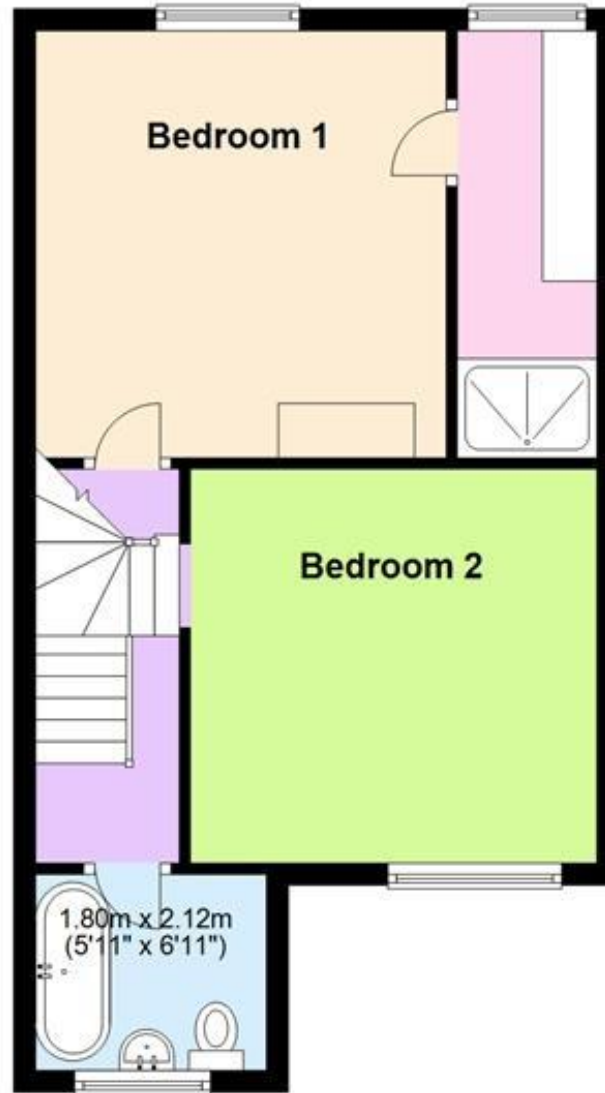

**Second Floor**

